

DWL

BL -02 -01 0 01 02 03 04 05 06 07 08 09 10 11 12 13 14 15 16 17 18 19 20 21 22 23

STB SIDE VIEW

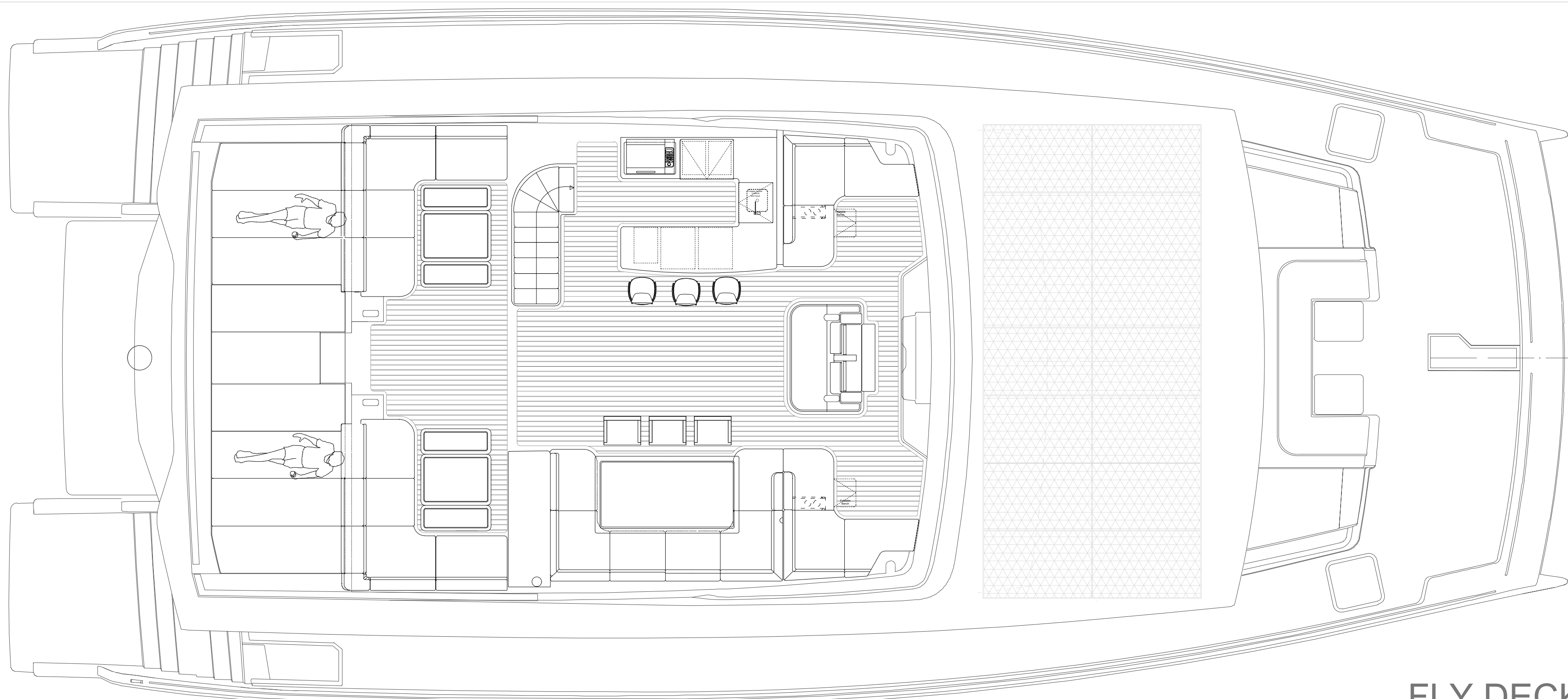

FLY DECK

BL -02 -01 0 01 02 03 04 05 06 07 08 09 10 11 12 13 14 15 16 17 18 19 20 21 22 23

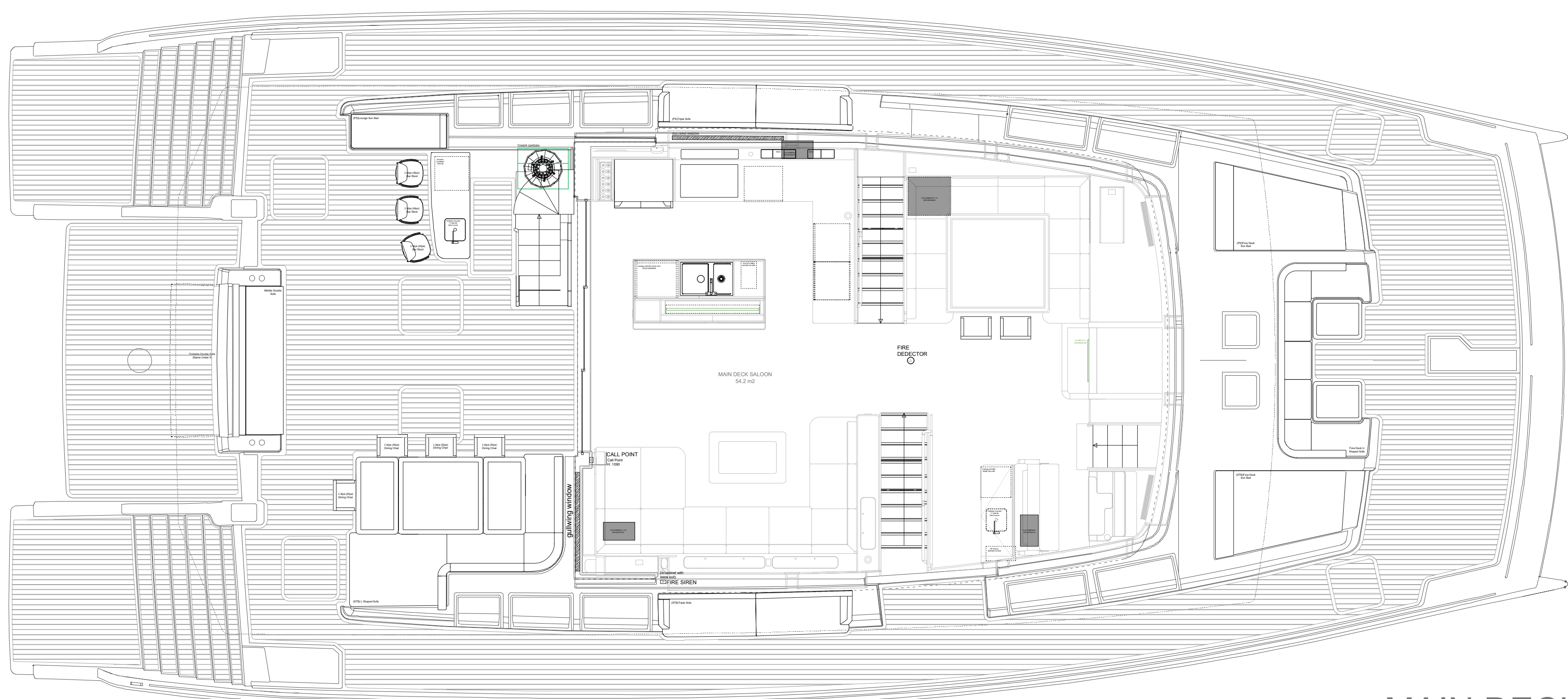

MAIN DECK

BL -02 -01 0 01 02 03 04 05 06 07 08 09 10 11 12 13 14 15 16 17 18 19 20 21 22 23

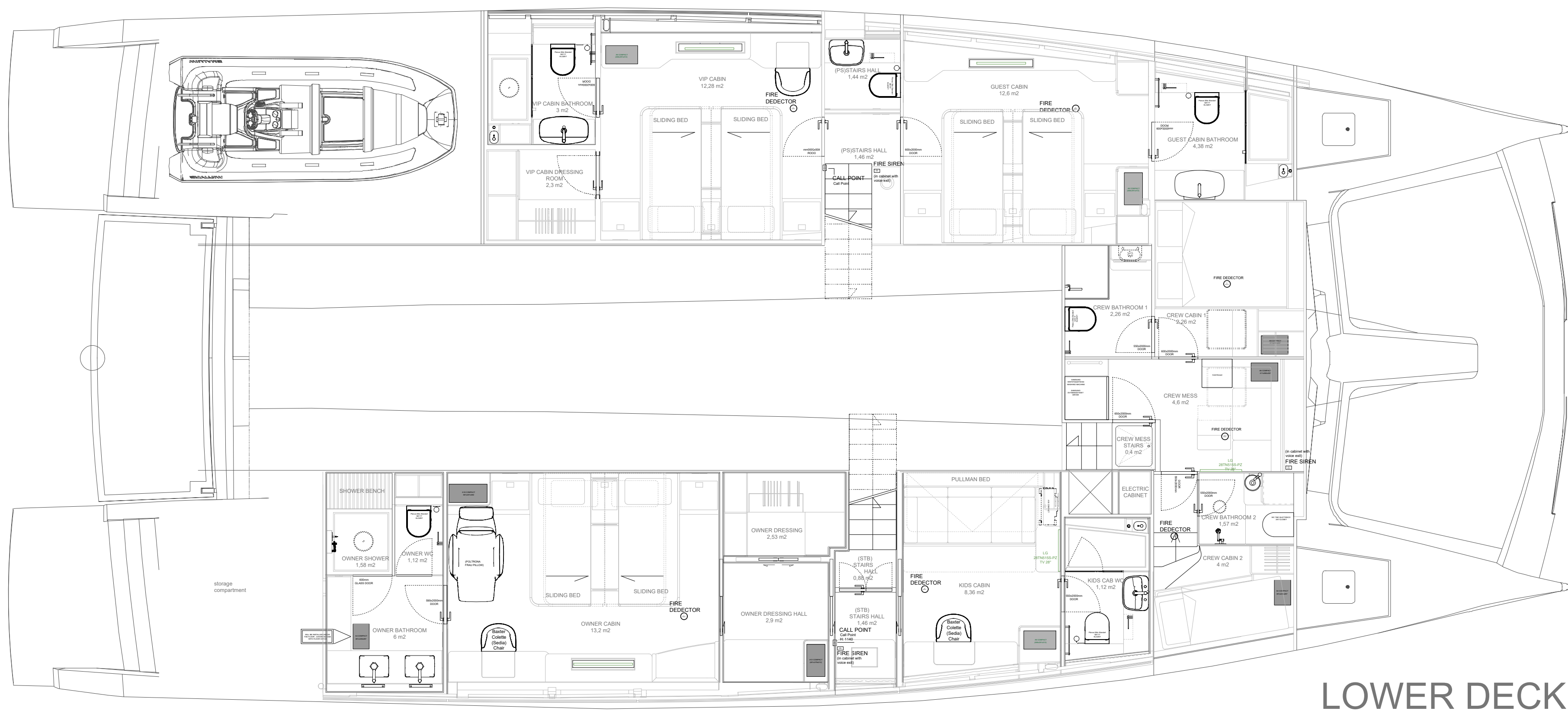

LOWER DECK

BL -02 -01 0 01 02 03 04 05 06 07 08 09 10 11 12 13 14 15 16 17 18 19 20 21 22 23

PRINCIPAL PARTICULARS	
Length overall	24.30 m.
Length waterline	23.97 m.
Beam overall	10.92 m.
Draft	1.58 m.
Deck to water level(bow)	2.7 m.
Deck to water level(cockpit)	2.02 m.
Bridge deck height	1.2 m.
Electric motors	2x340 kW
Battery	429 kWh
Certification	CE Category A

Revision	Status	Description	By	Checked

PROJECT : SV80.01
 SUBJECT : SV80.01 General Arrangement
 Drawing No : SV-100 Date : 03.03.2024
 Scale : 1/50
 Project : SV80.0100
 Designed by : Vision F Yachts
 Checked by : G.A.D.