

AB 100

HULL 195

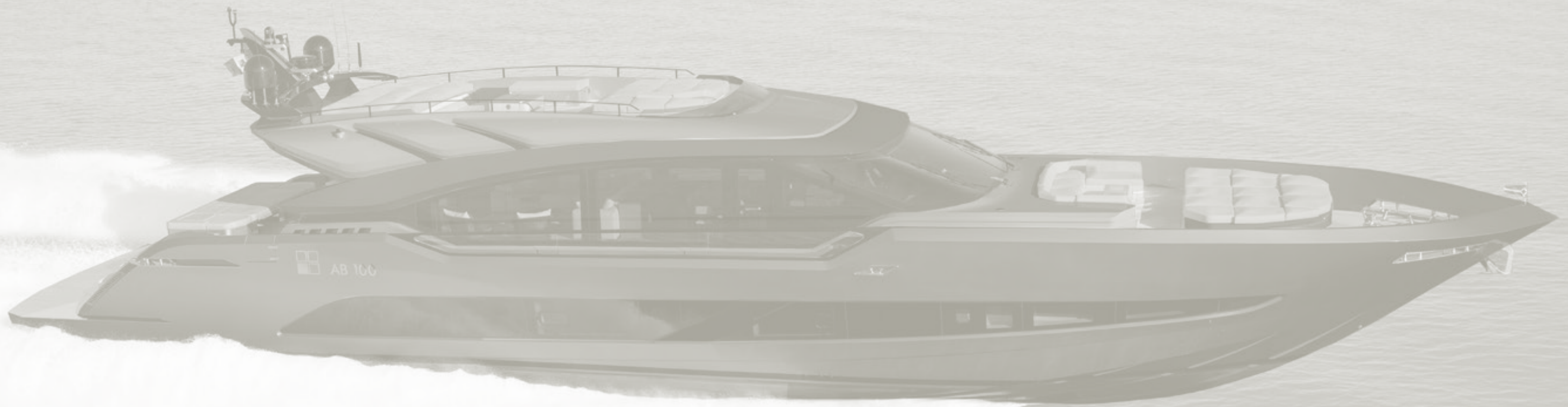

AB YACHTS

BETTER THAN BEST



AB 100











LIVING





OWNER CABIN



OWNER CABIN



VIP CABIN



OWNER BATHROOM



OWNER BATHROOM

AB100

CONSTRUCTION

Hull	COMPOSITE
Superstructure	COMPOSITE

DIMENSIONS

Length Overall L.O.A.	30.50 M / 100'
Beam	6.80 M / 22' 3"
Max Draft	1.30 M / 4' 3"
Displacement at full load	90 T / 198,416 LBS

TANK CAPACITY

Fuel Capacity	11,300 L / 2,985 US gal
Water Capacity	2,000 L / 528 US gal
Grey & Black Water	1,350 L / 356 US gal

PROPULSION

Main engine power	[3] MAN mod. V12-2000 of 2000 HP ea. (1471 kW @ 2300 rpm)
Transmission	[2] MJP steerable waterjets + [1] MJP (central booster) waterjet
Stabilization	Gyro Stabilizer SEAKEEPER mod.26 (zero speed and underway)

PERFORMANCE

Max speed	50+ knots
Cruising speed	45 knots
Range at cruising speed	~550 nm

ACCOMMODATIONS

Guests	Up to 9 in 4 cabins (4 bathrooms with ensuite shower)
Crew	3 in 2 cabins (2 bathrooms, 1 shower)

CLASSIFICATION

CE Certificate	Design Category A
Class Certificate	R.I.Na. - C ✘ HULL ● MACH Y Unrestricted Navigation

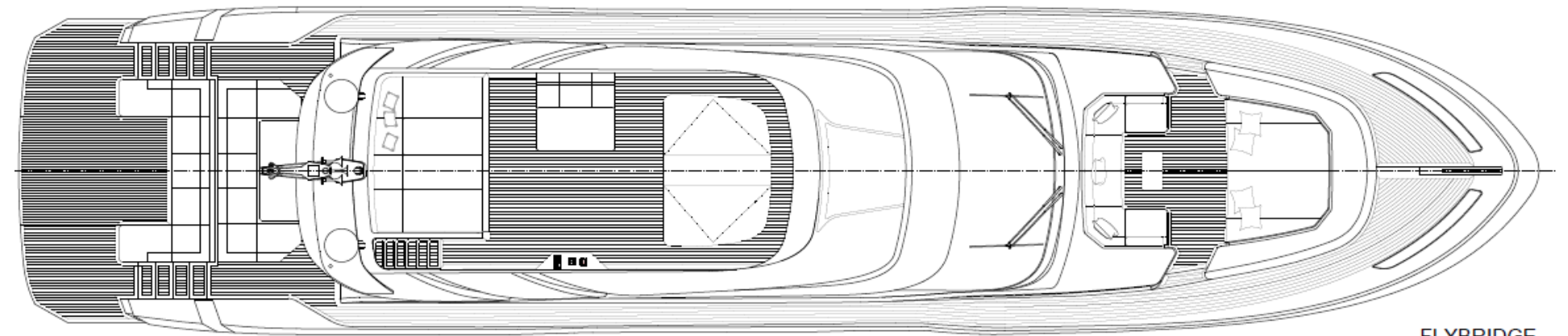
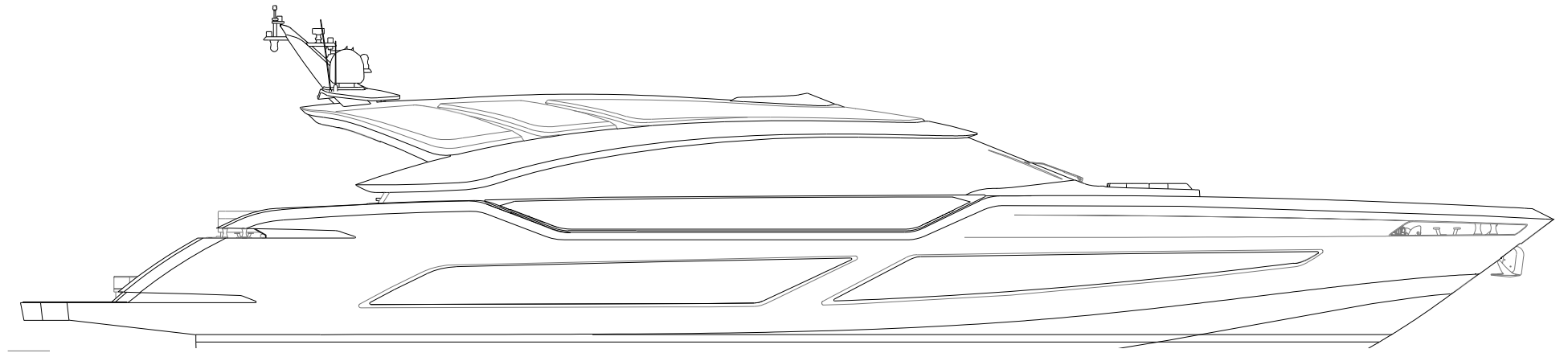

FLYBRIDGE

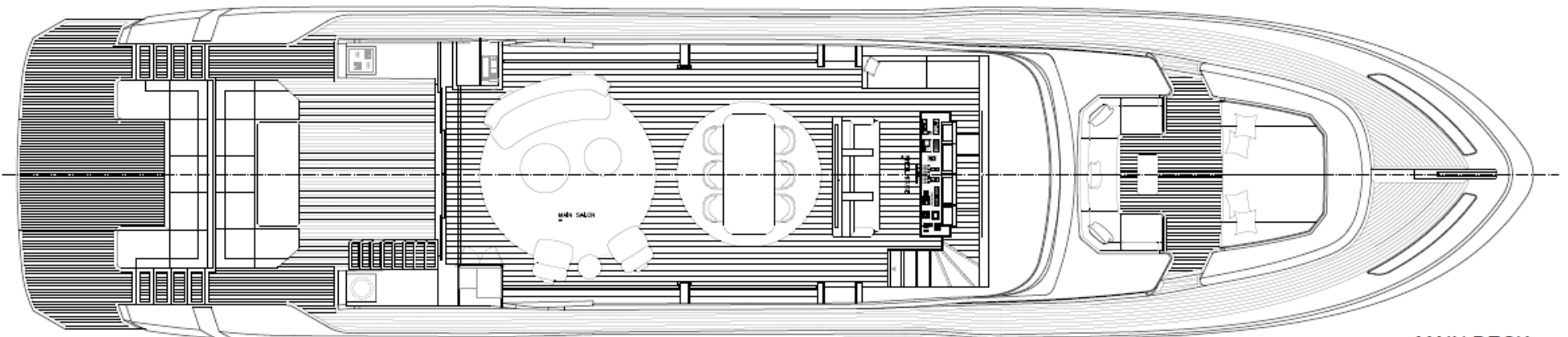

MAIN DECK

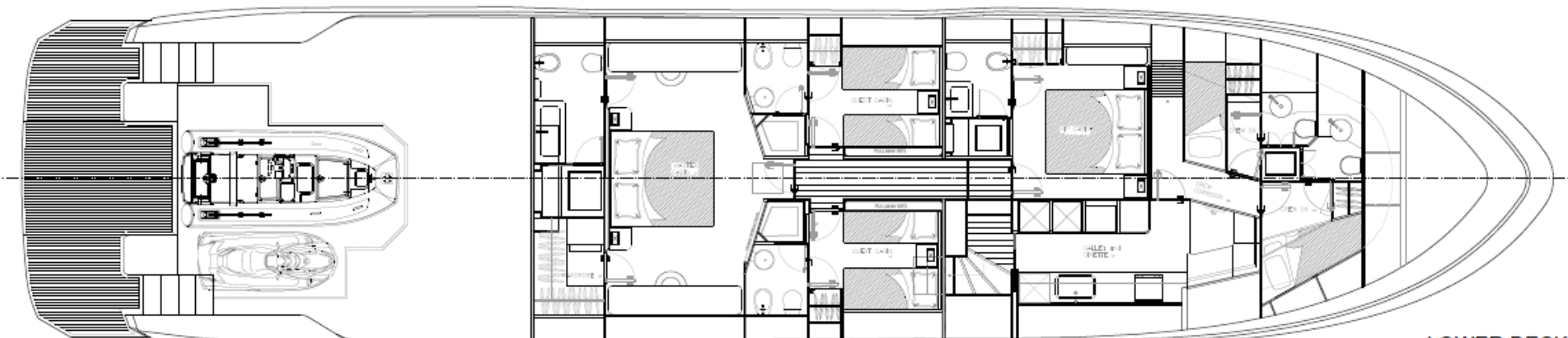

LOWER DECK

MOOD BOARD



MOROSO

Spring palette
1 cod: A8576



MASTROTTO

Linea Vogue
cod: 6041 Sea Otter

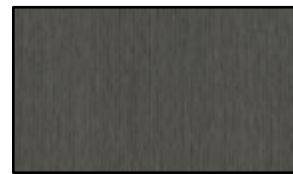

ALPI

Dark grey oak
cod: 11.04

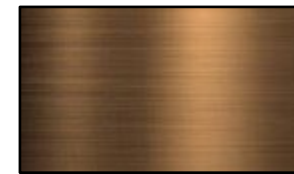

RAME

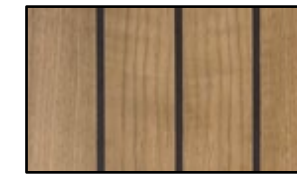

TEAK

YACHT CONFIGURATION

HOUSEHOLD APPLIANCES (Miele marine)

(Galley)

MIELE extractor hood 60cm

MIELE induction hob cooking top 60cm

MIELE multifunction oven 60cm

MIELE dishwasher 60cm

LIEBHERR double refrigerators 120cm

BARAZZA large stainless steel sink

(Salon)

INDEL undercounter fridge 60cm

(Engine Room)

BOSCH washer-dryer

NAVIGATION EQUIPMENT (Simrad)

RADAR SIMRAD HALO 24 48Mg

(2) MONITORS 19" SIMRAD NSO EVO3 S

(1) MONITOR 24" SIMARD NSOEVO3 S

(2) GPS ANTENNAS SIMRAD GS25

GP500 GPS

AIS SIMARD V3100 B Class

(2) TRANSDUCER SIMRAD SS60 Depth/Temp. 600W 50/200kHz

COMPASS SIMRAD Precision 9

AUTOPILOT SIMRAD AP70 with controller AC80A

BLACK BOX SIMRAD for VHF/AIS

WEATHER STATION - Wind, Temperature, Barometric sensors SIMRAD WX120

ANTENNA VHF NAVICO

(2) Handset VHF HS100 + SP100 Speaker SIMRAD

(2) VHFRS100S SIMRAD

(2) Remote OP50 SIMRAD

IS42 Colour instrument multifunction display SIMRAD

MONITORING SYSTEM for SIMRAD navigation equipment

AUDIO-VIDEO SYSTEM (Samsung, Crestron, iPad mini)

The audio-video SAMSUNG with CRESTRON music control via APPLE iPad for an easy and more intuitive use for all guests on board (as it follows):

YACHT CONFIGURATION

1. OWNER'S CABIN

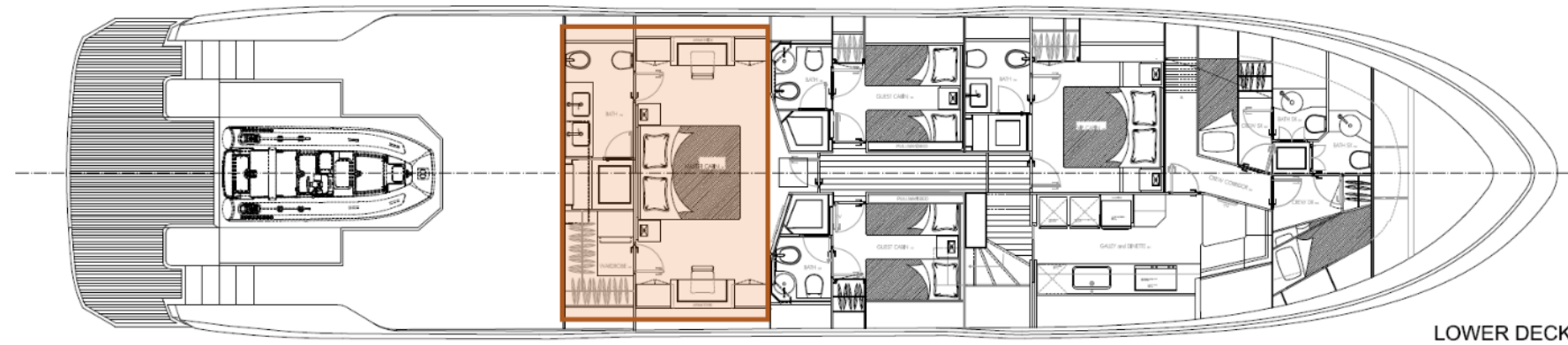

Equipment list

Sources

- Samsung Smart TV Led 43" 4K
- 1x HDMI & USB Wall Plate
- **Streaming:** Netflix, Disney+ ecc. via Smart TV. Spotify, Sirius and Airplay2 via Crestron amplifier

Speakers

- 2x Dynaudio P4-W65 speaker 6,5" rectangular

Control units

- 1x Apple iPad Mini 6 64GB Wi-Fi (Crestron configured)

System Features

The Owner's cabin will feature an Entertainment System with a Samsung Smart TV. The AV system will be integrated with all sources listed above, and controlled by a **dedicated 6TH Gen. iPad**. With this user interface, guests will be able to **control the Owner's cabin AV** sources.

YACHT CONFIGURATION

2. 1x VIP CABINS, 2x GUEST CABIN

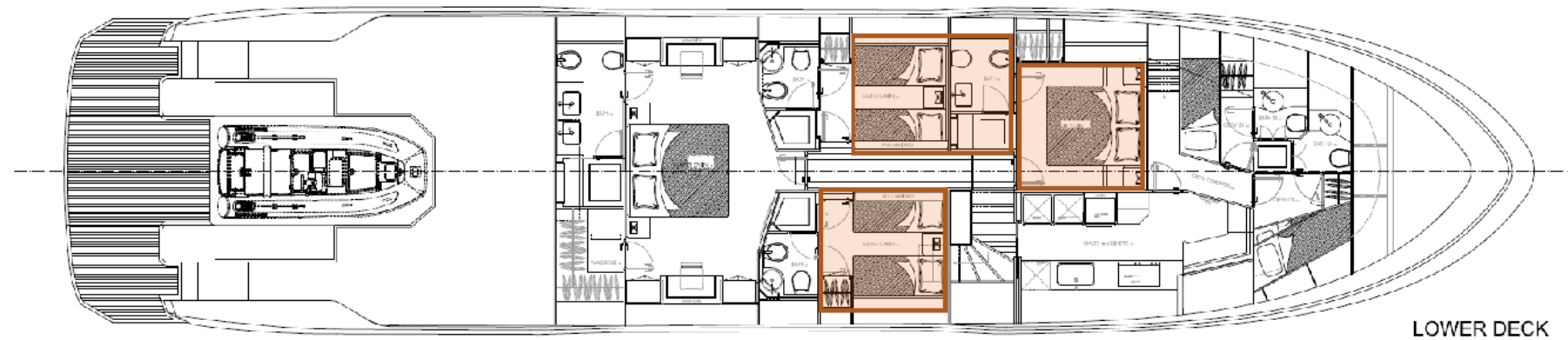

Equipment list per cabin

Sources

- Samsung TV LED 32" Full HD
- 1x HDMI & USB Wall Plate
- **Streaming:** Netflix, Disney+ ecc. via Smart TV. Spotify, Sirius and Airplay2 via Crestron amplifier

Speakers

- 2x Dynaudio P4-W65 rectangular speaker 6,5"

Control units

- 1x Apple iPad Mini 6 64GB Wi-Fi (Crestron configured)

System Features

The cabins will feature an **Entertainment System** with a Samsung Full Led HD TV. The **AV system** will be integrated with all sources listed above, and controlled by a **dedicated 6th gen. iPad**. With this user interface, guests will be able to **control each cabin AV sources**.

YACHT CONFIGURATION

3. MAIN SALON

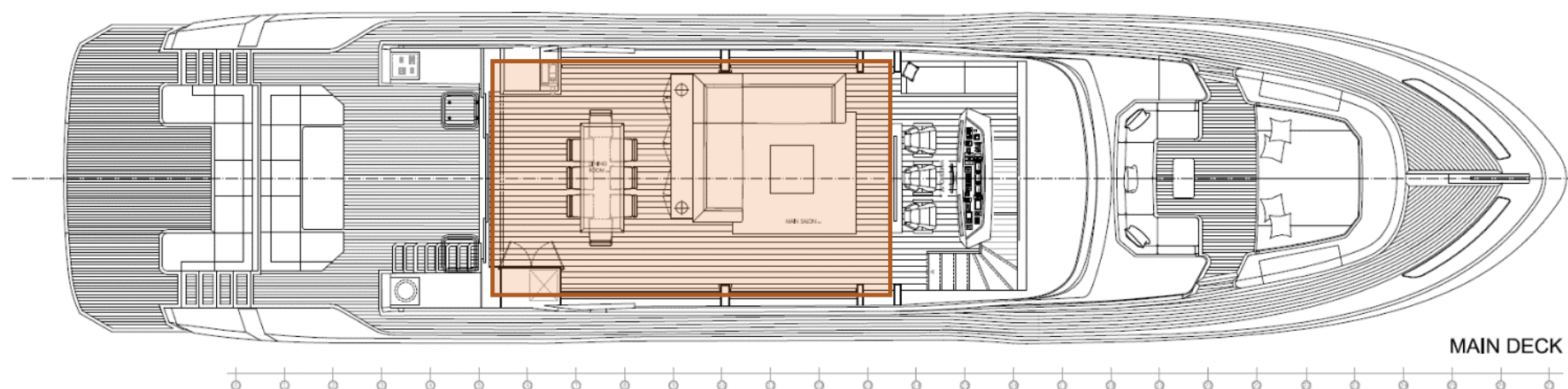

Equipment list

Sources

- Samsung Smart TV 55" 4K QLED
- 1x HDMI & USB Wall Plate
- **Streaming:** Netflix, Disney+ ecc. via Smart TV. Spotify via Marantz amplifier

Speakers

- 7x Dynaudio P4-W65 rectangular speaker 6,5"
- 1x B&W subwoofer ASW608

Control units

- 1x Apple iPad Mini 6 64GB Wi-Fi (Crestron configured)

System Features

The Main Salon will feature an **Entertainment System** with a **Samsung Smart TV 55" 4K** and a surround audio system thanks to a set of in-ceiling Dynaudio speakers with a B&W subwoofer. The **AV system** will be integrated with all sources listed above, and controlled by a **dedicated 6th gen. iPad**. With this user interface, guests will be able to **control the Main Salon AV sources**.

YACHT CONFIGURATION

4. EXTERNAL AREAS

Equipment list (for BEACH, AFT DECK, BOW AND FLYBRIDGE)

- JL-Audio waterproof Speakers 6,5" - 4x in the Aft Dec
- Crestron multichannel streaming amplifier 16ch, 300w with built in Airplay 2, Spotify Connect, Sirius XM

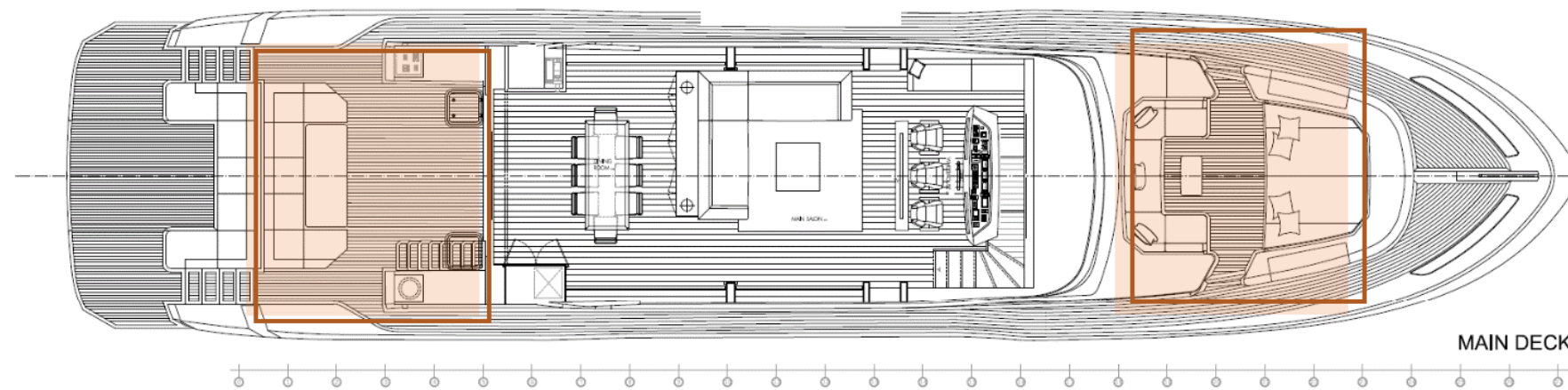
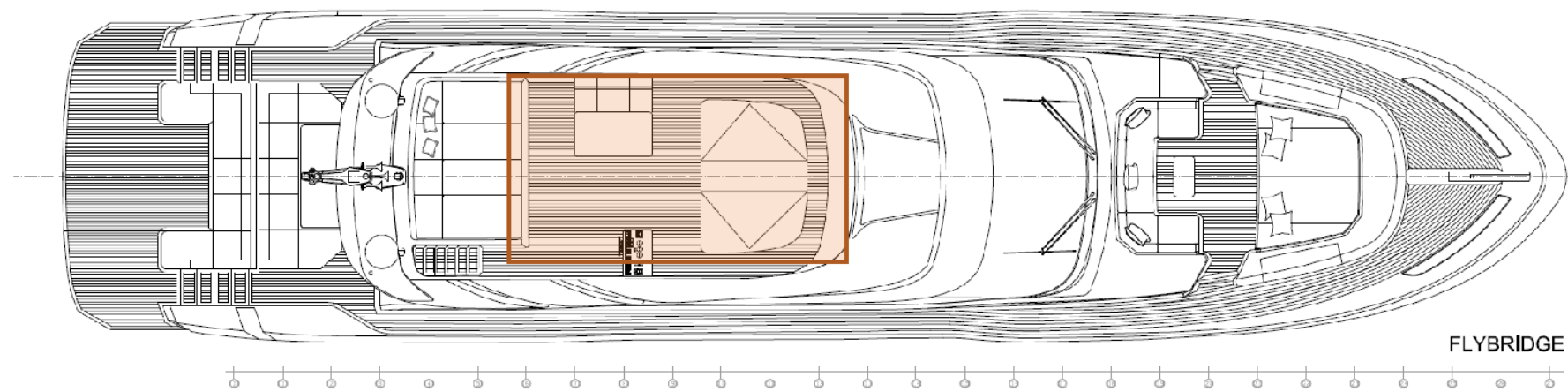

YACHT CONFIGURATION

IT and Wi-Fi

Equipment list

- 1x Peplink 4G router with one SIM card and Wi-Fi receiver for Marina hotspot communications
- 1x Ubiquiti Dream Machine Pro Router wireless controller, Firewall
- 1x Ubiquiti with 48 POE switch for all physical ethernet connections
- 5x Ubiquiti Access Point UniFi 6 Long-Range 3000 Mbit/s PoE (distributed across all decks)
- 2x Poynting Marine & Coastal Wi-Fi Gain 9dBi
- 2x Poynting Marine & Coastal LTE Gain 9dBi

System Features

The IT system on board will allow the boat to connect to the internet with **2 SIM cards 4G LTE** and **Marina Wi-Fi**. The 4 antennas on the mast will guarantee a high-quality reception of 4G data and Wi-Fi signals.

CCTV

Equipment list

- 3x DAHUA SD22404T-GN-S2 Mini PTZ network camera
- 1x DAHUA NVR4208 NVR recorder 8 ch

System Features

The proposed CCTV cameras system is designed to provide **24/7 surveillance across all decks**. The Crew on board will be able to monitor movements of the boat while maneuvering or sailing. The **NVR recorder guarantees up to 6TB of digital recordings** in high resolution. Cameras can be displayed on the wheelhouse monitor and controlled with a trackpad.

OPTIONAL INCLUDED

- Arch. MARCO CASAMONTI (Studio Archea, Florence) - Exclusive Interior Designer Premium Package
- RINA Class Certificate - Unrestricted Navigation (Pleasure)
- Nr. 4 Underwater lights on the transom (fixed white light)
- Dark grey Metallic paint
- Aft Control Station
- Parallel system
- Seamless Transfer: "No-power-blackout" smart technology in order to avoid the blackouts from switching the genset power onto the shore power supply, and viceversa
- Flydeck mini pilot station
- Gyroscope stabilizer Seakeeper mod. 26: working at anchor ("Zero Speed") and in navigation ("underway")
- AIS + Weather Station
- Night vision camera predisposition (camera not included)
- Outside shade tent aft-located (2 poles) and at bow (4 poles), and on the flydeck (6 poles): complete with carbon fibre poles and micro-holed fabric (mesh type)
- Electric blind curtains in the Salon
- Electric blind curtains in the Lower Deck's accommodations
- Electric black-out rollers in the Lower Deck's accommodations
- One (1) 130Lt/hr Watermaker
- CCTV (3-camera) system
- LAN and WiFi NETWORK: innovative SNIPER 5G system
- Portholes sensors
- SeaTel ST24 TV Antenna
- Monitoring System
- Teak on Flydeck

Tender 4.50 meters + Jet ski (3-seat personal water craft) not included.

For any other possible item or custom request, the Shipbuilder will evaluate the feasibility and in case will provide a quotation